



Kōura



Kōura



The droplet-like shape of Kōura emulates the curled form of the native freshwater shrimp, kōura, named by the indigenous Māori people. David was also inspired by the intricately crafted traps used by early Māori to catch kōura. Primarily used as a feature sculptural lighting piece, Kōura draws attention to specific locations, often hanging over a bar, in an entry space, stairwell, or hall.

Its presence has a calm purity and beauty, which can be enhanced by the chosen finish.

Kōura is available in various sizes to suit any space. The plywood finish can be either raw bamboo or painted, offering a range of options.



Features

Shipped Kitset

Seed System kitset lightshades are on average 1/30th of the volume of the assembled light. This aims to help minimize the effects of shipping and to reduce the design's environmental footprint.

Warranty

This light is warranted for three years from date of purchase for failure of parts.

Care Instructions

All lights are intended for use in dry interior conditions only and can be cleaned with a soft cloth dampened slightly in warm water when the light is switched off. Do not use detergents.

EPD Certified

An EPD is a standardised and verified way of quantifying the environmental impacts of a product, based on a consistent set of rules that have been developed through a stakeholder consultation process.



Compliance



CE



AS/NZS

(Declarations of conformity available on request).



david
trubridge

david
trubridge

david
trubridge

Kaura
750mm (29")

Blue
1 Side

Bamboo

Kaura
1000mm (39")

Aqua
1 Side

Bamboo



Technical Data



500mm/20" 750mm/29" 1000mm/39" 1200mm/47" 1600mm/63" 2000mm/79" 2400mm/94"

500mm/20"	750mm/29"	1000mm/39"	1200mm/47"	1600mm/63"	2000mm/79"	2400mm/94"
Width: 300mm / 12"	Width: 420mm / 17"	Width: 550mm / 22"	Width: 677mm / 27"	Width: 950mm / 37"	Width: 1100mm / 43"	Width: 1400mm / 55"
Height: 500mm / 20"	Height: 750mm / 30"	Height: 970mm / 38"	Height: 1200mm / 47"	Height: 1600mm / 63"	Height: 2000mm / 79"	Height: 2400mm / 94"
Weight: 0.45kg / 0.99lb	Weight: 0.75kg / 1.65lb	Weight: 1.8kg / 3.96lb	Weight: 2.2kg / 4.85lb	Weight: 7kg / 15.43lb	Weight: 10kg / 22.04lb	Weight: 12.5kg / 27.55lb
2m / 6.5ft	2m / 6.5ft	2m / 6.5ft	3m / 9.8ft	5m / 16.4ft	5m / 16.4ft	5m / 16.4ft
Bamboo plywood (Sourced from FSC accredited factory)	Bamboo plywood (Sourced from FSC accredited factory)	Bamboo plywood (Sourced from FSC accredited factory)	Bamboo plywood (Sourced from FSC accredited factory)	Bamboo plywood (Sourced from FSC accredited factory)	Bamboo plywood (Sourced from FSC accredited factory)	Bamboo plywood (Sourced from FSC accredited factory)
Nylon	Nylon	Nylon	Nylon	Nylon	Nylon	Nylon
Hangs on cord	Hangs on cord	Hangs on cord	Hangs on cord	3 x Suspension Wires	3 x Suspension Wires	3 x Suspension Wires
565mm x 185mm x 70mm	880mm x 200mm x 70mm	740mm x 250mm x 90mm	830mm x 305mm x 60mm	1255mm x 370mm x 190mm	1375mm x 450mm x 160mm	1780mm x 530mm x 160mm
22" x 7" x 3"	35" x 8" x 3"	29" x 10" x 3"	33" x 12" x 2"	49" x 15" x 7"	54" x 18" x 6"	70" x 21" x 6"
0.007m / 0.3ft	0.012m / 0.435ft	0.017m / 0.600ft	0.015m / 0.53ft	0.088m / 3.1ft	0.100m / 3.531ft	0.151m / 5.332ft
0.9kg / 2lb	2kg / 4.41lb	3kg / 6.61lb	3.5kg / 7.7lb	9.2kg / 20.3lb	20kg / 44.09lb	30kg / 66.13lb

Dimensions

Cordset*

Material

Fasteners

Suspension

Packaging

*Black comes with black cordset and fasteners. All others come with white cordset and white fasteners. Custom cordset lengths available on request.

Finishes

We offer 12 stock finish options for Kōura. We use low VOC acrylic paint and it is most commonly used on the interior of the light. We can also produce lights in other finishes or colours by special order. All lights are made from sustainably grown bamboo plywood sourced from an FSC accredited factory.



Raw Finish

Bamboo

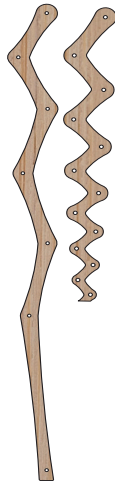

Painted 2 Sides

Black



White

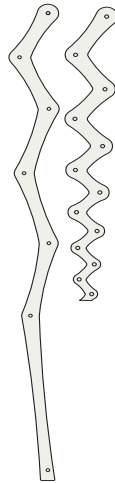

Painted 1 Side

Blue

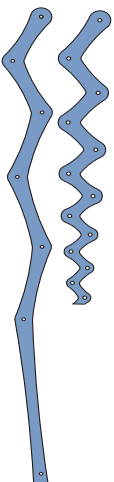

Aqua

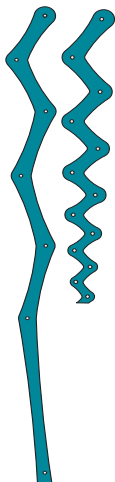

Lime

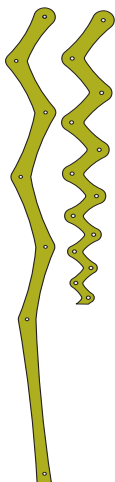

Orange

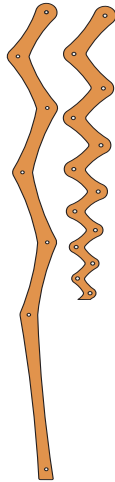

Pink

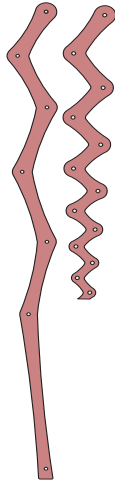

Red

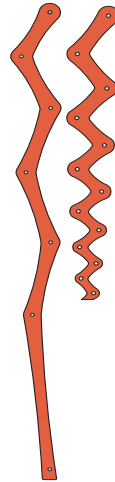

Black



White

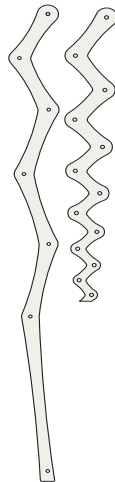

*Finishes apply to all Kōura sizes



Electrics

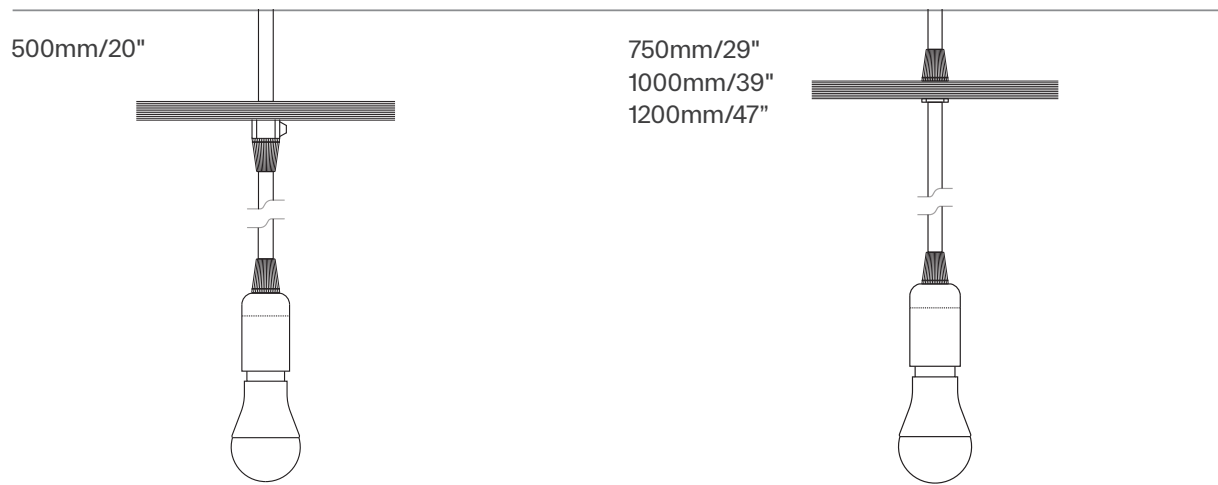

North America: E26,
Max 60 Watts 120v AC
60hz
Rest of World: E27,
Max 60 Watts
230-240v AC 50hz

North America: E26,
Max 60 Watts 120v
AC 60hz
Rest of World: E27,
Max 60 Watts
230-240v AC 50hz

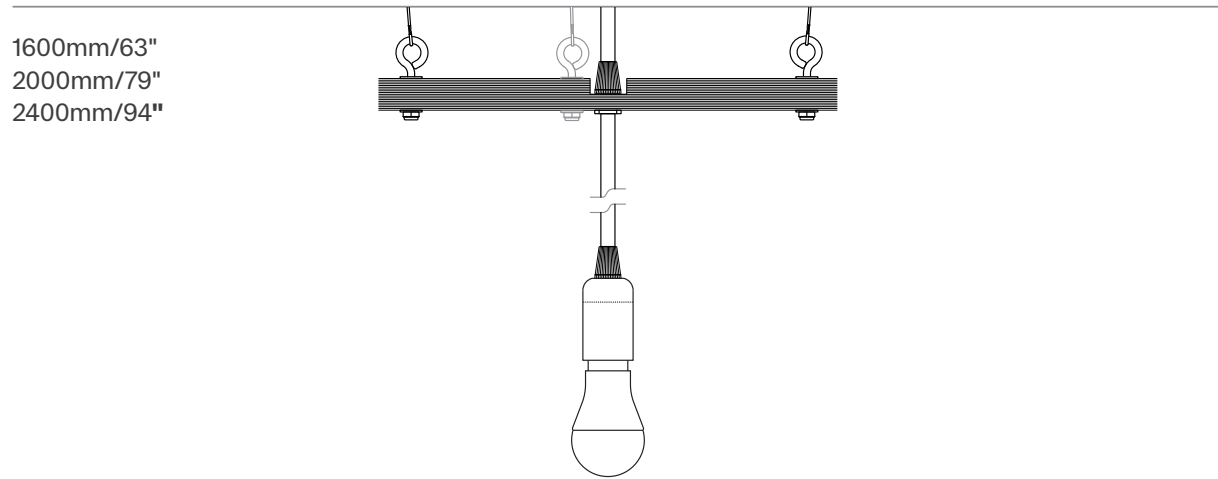

North America: E26,
Max 60 Watts 120v AC
60hz
Rest of World: E27,
Max 60 Watts
230-240v AC 50hz

Installation

1600mm/63"

2000mm/79"

2400mm/94"

Fixings for cone gripper (fixing screws NOT SUPPLIED).
 Note: Choose appropriate hardware to attach base plate (Fig.1) to ceiling substrate.

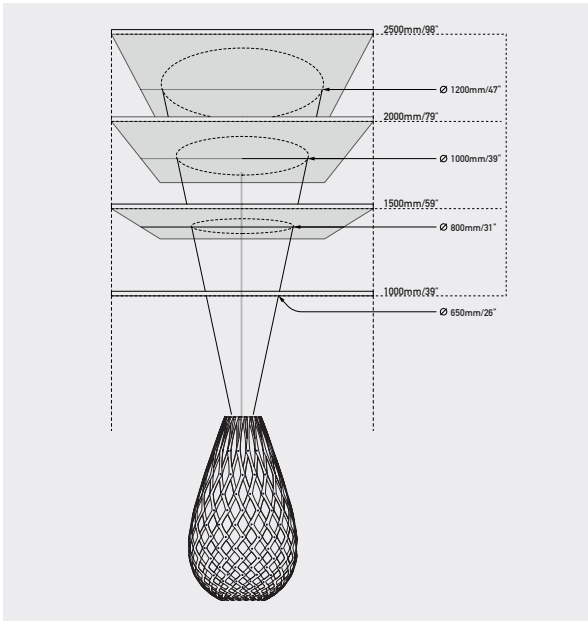
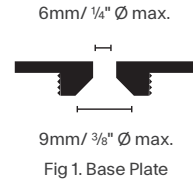

Step 1.
 Decide upon hanging distance. Use the schematic diagram as a guide to pick a circle radius to be marked out on ceiling. This circle can be marked with a length of timber or string.

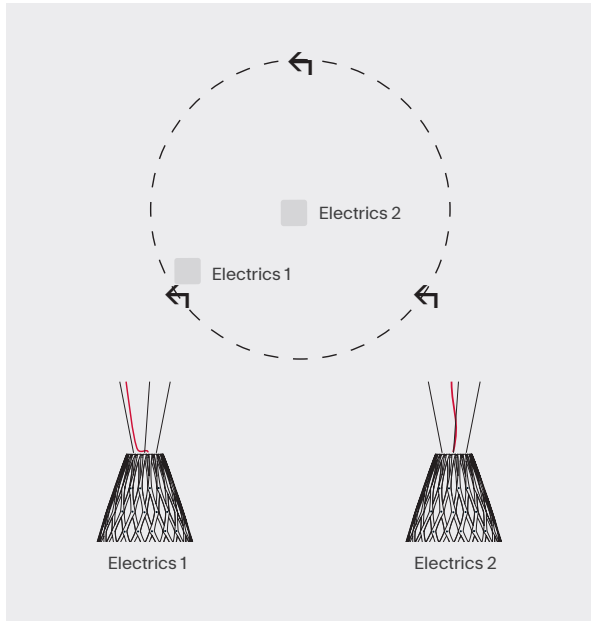

Step 2.
 Mark 3 hanging points where your cone grippers will be located. You can either centrally locate the ceiling canopy or run the electric cord up one of the suspension wires.

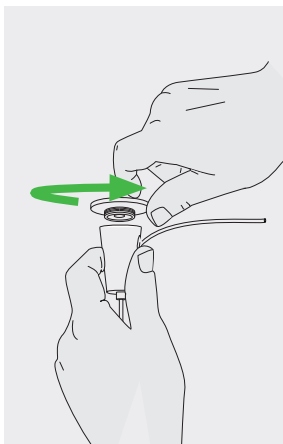

Step 1.
 Unscrew baseplate.

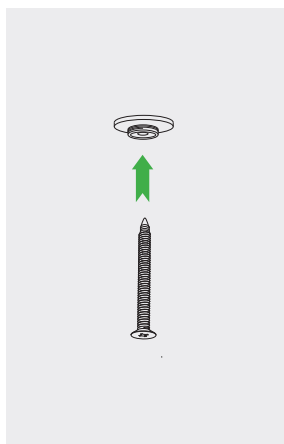

Step 2.
 Use appropriate fixing screw to mount base plate (Fig.1).

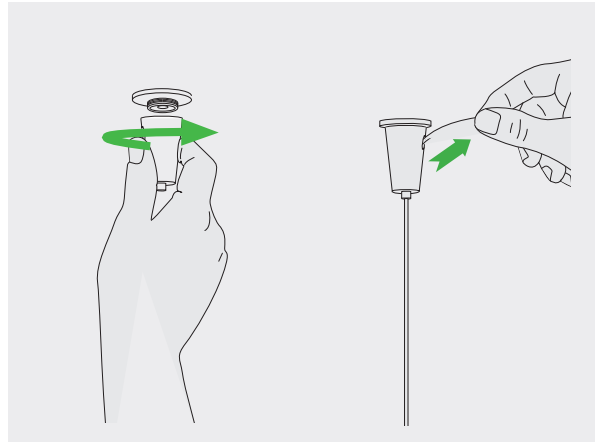

Step 3.
 Remove cable from cone. Screw cone back onto baseplate. Re-insert cable and level light. Once desired position is set, trim excess cable.