



Snowflake



Snowflake



Snowflake was designed following a trip David made to Antarctica as a visiting artist.

Snowflake is assembled from a hexagonal snowflake shape which creates a repeating geometric pattern. It builds on the process he first developed with Coral of using minimal thin sheet material in compound curvature to create.

Snowflake comes in three sizes: 800mm (31"), 1000mm (39"), and 1600mm (63"), making it suitable for any space. The plywood finish is available in either raw bamboo or painted, offering a range of options



Features

Shipped Kitset

Seed System kitset lightshades are on average 1/30th of the volume of the assembled light. This aims to help minimize the effects of shipping and to reduce the design's environmental footprint.

Warranty

This light is warranted for three years from date of purchase for failure of parts.

Care Instructions

All lights are intended for use in dry interior conditions only and can be cleaned with a soft cloth dampened slightly in warm water when the light is switched off. Do not use detergents.

EPD Certified

An EPD is a standardised and verified way of quantifying the environmental impacts of a product, based on a consistent set of rules that have been developed through a stakeholder consultation process.



Compliance



CE



AS/NZS

(Declarations of conformity available on request).





Technical Data



800mm/31"

1000mm/39"

1600mm/63"

Width: 800mm / 31"
Height: 400mm / 16"
Weight: 1.7kg / 3.74lb

Width: 1000mm / 39"
Height: 500mm / 20"
Weight: 2.5kg / 5.51lb

Width: 1600mm / 63"
Height: 700mm / 28"
Weight: 11.2kg / 24.69lb

2m / 6.5ft

2m / 6.5ft

5m / 16.4ft

Bamboo plywood
(Sourced from FSC accredited factory)

Bamboo plywood
(Sourced from FSC accredited factory)

Bamboo plywood
(Sourced from FSC accredited factory)

Nylon

Nylon

Aluminium

1 x Suspension Wire

1 x Suspension Wire

3 x Suspension Wires

470mm x 360mm x 80mm
19" x 14" x 3"
0.014m / 0.478ft
2.2kg / 4.85lb

530mm x 450mm x 80mm
21" x 18" x 3"
0.019m / 0.674ft
3.2kg / 7.05lb

1650mm x 1650mm x 850mm
65" x 65" x 33"
2.314m / 81.723ft
160kg / 352.74lb

Dimensions

Cordset*

Material

Fasteners

Suspension

Packaging

*Black comes with black cordset and fasteners. All others come with white cordset and white fasteners. Custom lengths available on request.

Finishes

We offer 12 stock finish options for Snowflake. We use low VOC acrylic paint and it is most commonly used on the interior of the light. We can also produce lights in other finishes or colours by special order. All lights are made from sustainably grown bamboo plywood sourced from an FSC accredited factory.



Raw Finish

Bamboo

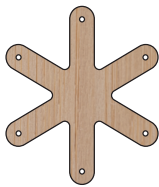

Painted 2 Sides

Black



White

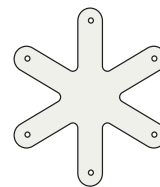

Painted 1 Side

Blue

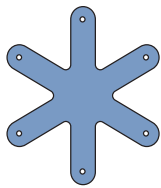

Aqua

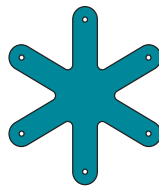

Lime

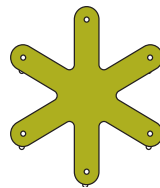

Orange

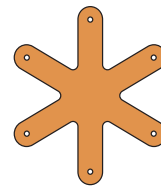

Pink

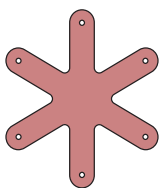

Red

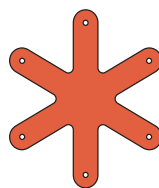

Black



White

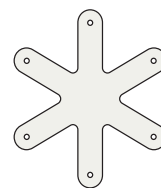



Bamboo

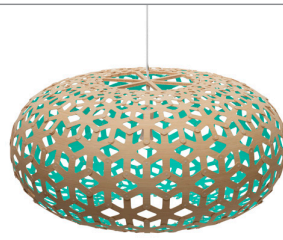

Aqua



Lime



Red



Orange

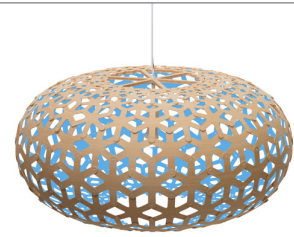

Blue



Pink



Black 1 Side (Outside)



Black 1 Side (Inside)



Black 2 Sides



White 1 Side



White 2 Sides

Electrics

800mm/31"
1000mm/39"

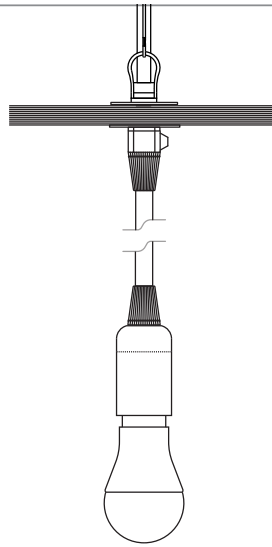

North America: E26,
Max 60 Watts 120v AC
60hz
Rest of World: E27,
Max 60 Watts
230-240v AC 50hz

1600mm/63"

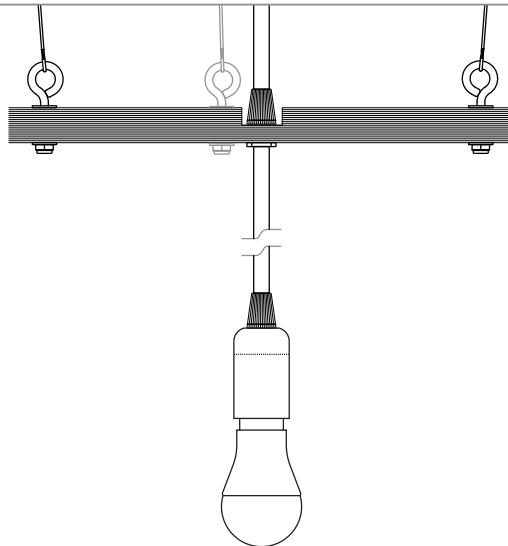

North America: E26,
Max 60 Watts 120v AC
60hz
Rest of World: E27,
Max 60 Watts
230-240v AC 50hz

Installation

1000mm/39"

1600mm/63"

Fixings for cone gripper (fixing screws NOT SUPPLIED).
 Note: Choose appropriate hardware to attach base plate (Fig.1) to ceiling substrate.

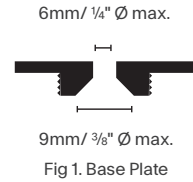

1600mm/63"

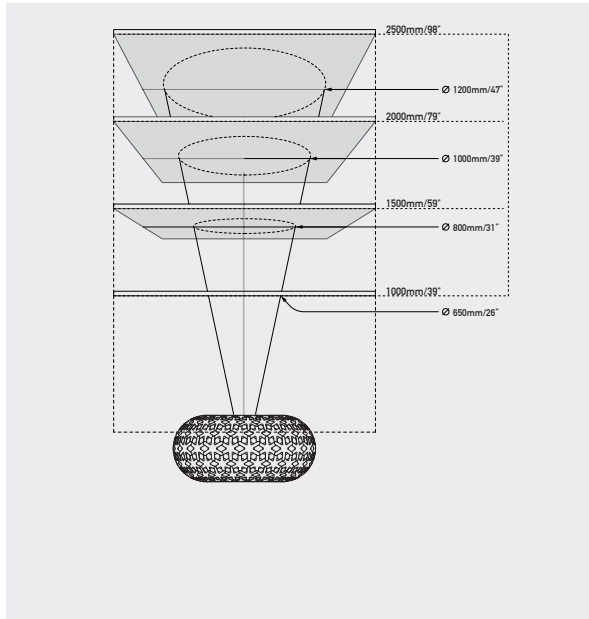

Options

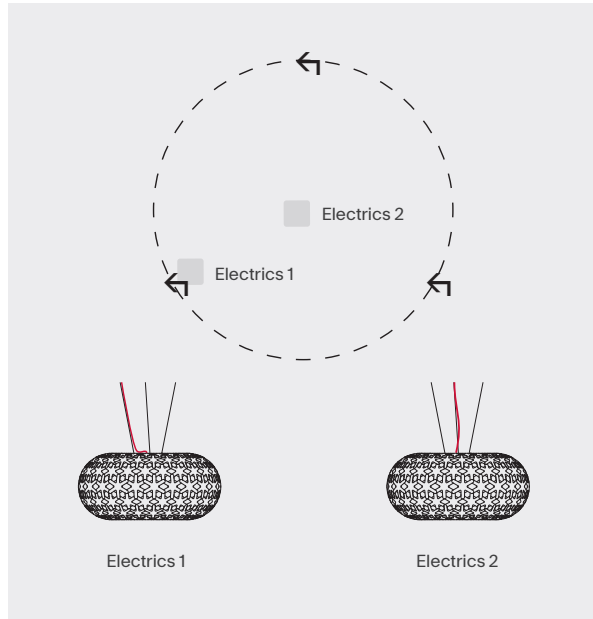

Step 1.

Decide upon hanging distance. Use the schematic diagram as a guide to pick a circle radius to be marked out on ceiling. This circle can be marked with a length of timber or string.

Step 2.

Mark 3 hanging points where your cone grippers will be located. You can either centrally locate the ceiling canopy or run the electric cord up one of the suspension wires.

Installation -1000mm/39" + 1600mm63"

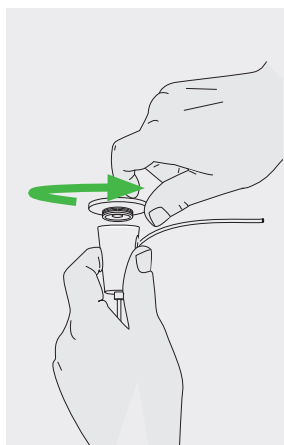

Step 1.

Unscrew baseplate.

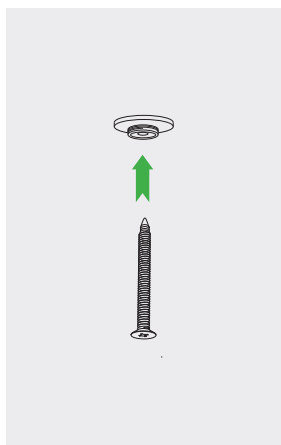

Step 2.

Use appropriate fixing screw to mount base plate (Fig.1).

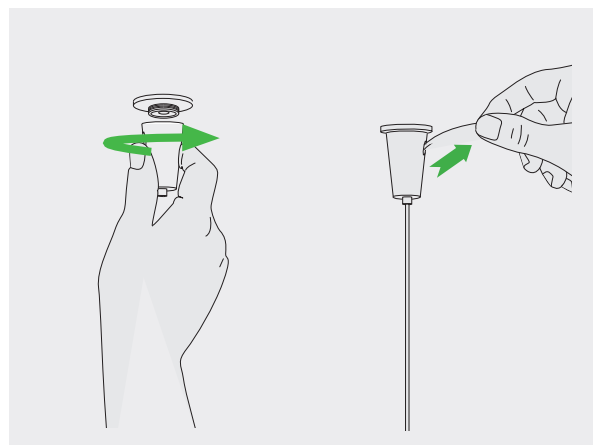

Step 3.

Remove cable from cone. Screw cone back onto baseplate. Re-insert cable and level light. Once desired position is set, trim excess cable.