



Flax



Flax



Flax Pendant is based on the long slender leaves of the indigenous flax plant or harakeke in that has long been grown for its valuable fibre. There is a Māori proverb about preserving important resources: If you cut the central stalk of the flax bush, where will the bellbird feed?

Flax comes in 3 sizes; 800mm, 1100mm and 1500mm. The shallow form lends itself to lower ceiling spaces. The plywood finish can be either raw bamboo or painted, offering a range of options.



Features

Shipped Kitset

Seed System kitset lightshades are on average 1/30th of the volume of the assembled light. This aims to help minimize the effects of shipping and to reduce the design's environmental footprint.

Warranty

This light is warranted for three years from date of purchase for failure of parts.

Care Instructions

All lights are intended for use in dry interior conditions only and can be cleaned with a soft cloth dampened slightly in warm water when the light is switched off. Do not use detergents.

EPD Certified

An EPD is a standardised and verified way of quantifying the environmental impacts of a product, based on a consistent set of rules that have been developed through a stakeholder consultation process.



Compliance



CE



AS/NZS

(Declarations of conformity available on request).





Technical Data

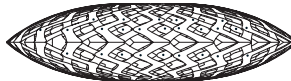

800mm/31"

1100mm/43"

1500mm/59"

Width: 800mm / 31"
 Height: 220mm / 9"
 Weight: 1.5kg / 3.30lb

Width: 1100mm / 43"
 Height: 290mm / 11"
 Weight: 2.6kg / 5.73lb

Width: 1500mm / 59"
 Height: 325mm / 13"
 Weight: 7kg / 15.4lb

2m / 6.5ft

3m / 9.8ft

5m / 16.4ft

Bamboo plywood
 (Sourced from FSC accredited factory)

Bamboo plywood
 (Sourced from FSC accredited factory)

Bamboo plywood
 (Sourced from FSC accredited factory)

Nylon

Nylon

Nylon

Hangs on cord

Hangs on cord

3 x Suspension Wires

395mm x 335mm x 105mm
 16" x 13" x 4"
 0.014m / 0.5ft
 2.1kg / 4.63lb

530mm x 450mm x 80mm
 21" x 18" x 3"
 0.019m / 0.67ft
 3.8kg / 8.4lb

750mm x 590mm x 205mm
 30" x 23" x 8"
 0.091m / 3.2ft
 9.5kg / 20.943lb

Dimensions

Cordset*

Material

Fasteners

Suspension

Packaging

*Black comes with black cordset and fasteners. All others come with white cordset and white fasteners. Custom cordset lengths available on request.

Finishes

We offer 12 stock finish options for Flax. We use low VOC acrylic paint and it is most commonly used on the interior of the light. We can also produce lights in other finishes or colours by special order. All lights are made from sustainably grown bamboo plywood sourced from an FSC accredited factory.



Raw Finish

Bamboo



Painted 2 Sides

Black

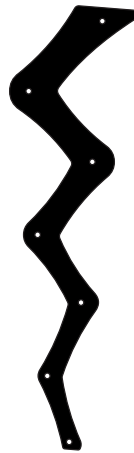

White

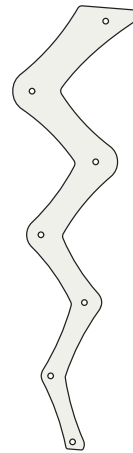

Painted 1 Side

Blue

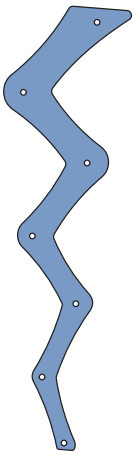

Aqua

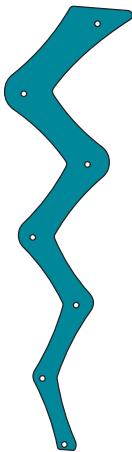

Lime

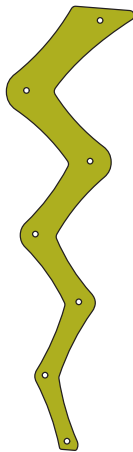

Orange

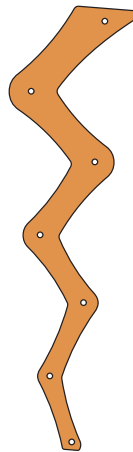

Pink

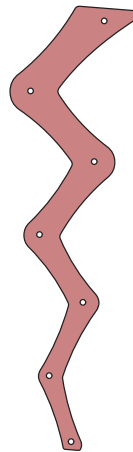

Red

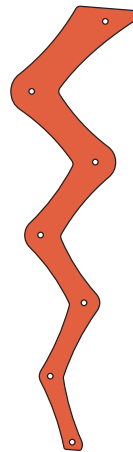

Black

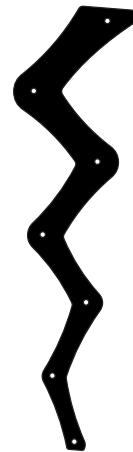

White

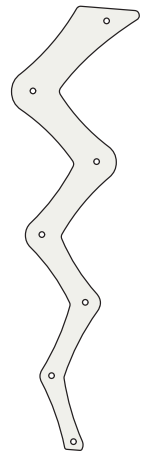

*Finishes apply to all Flax sizes



Bamboo

Aqua

Lime



Red

Orange

Blue



Pink

Black 1 Side (Outside)

Black 1 Side (Inside)



Black 2 Sides

White 1 Side

White 2 Sides

Electrics

800mm / 31"
1100mm / 55"

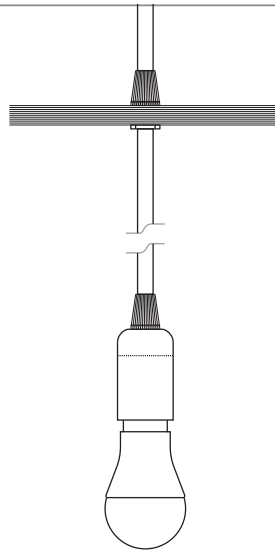

North America: E26,
Max 60 Watts 120v AC
60hz
Rest of World: E27,
Max 60 Watts
230-240v AC 50hz

1500mm/59"

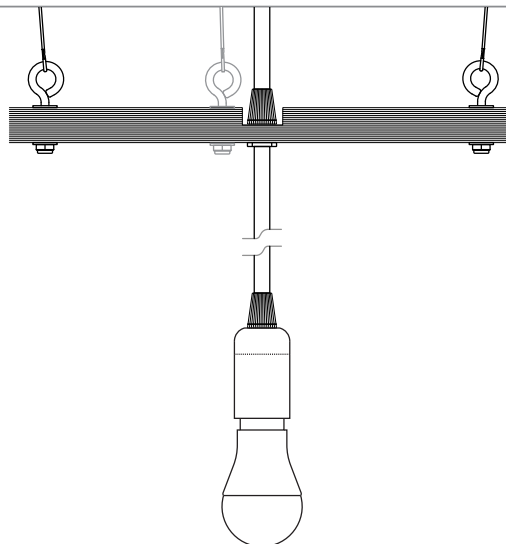

North America: E26, Max
60 Watts 120v AC 60hz
Rest of World: E27, Max 60
Watts
230-240v AC 50hz

Installation

1500mm/59"

Fixings for cone gripper (fixing screws NOT SUPPLIED).
 Note: Choose appropriate hardware to attach base plate (Fig.1) to ceiling substrate.

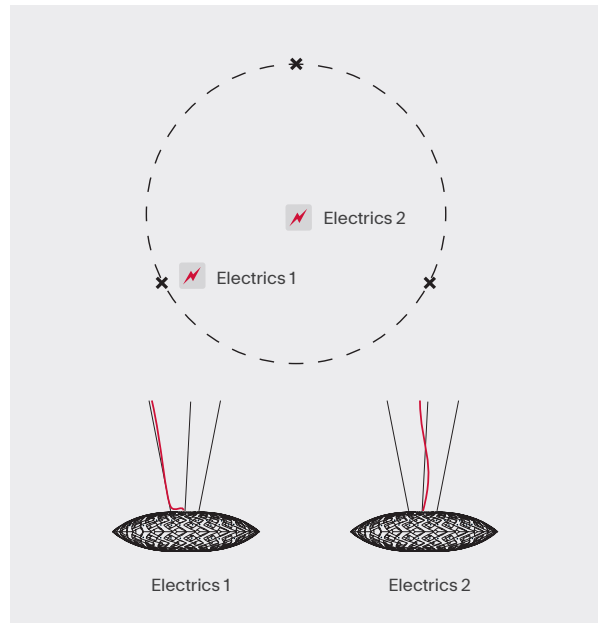
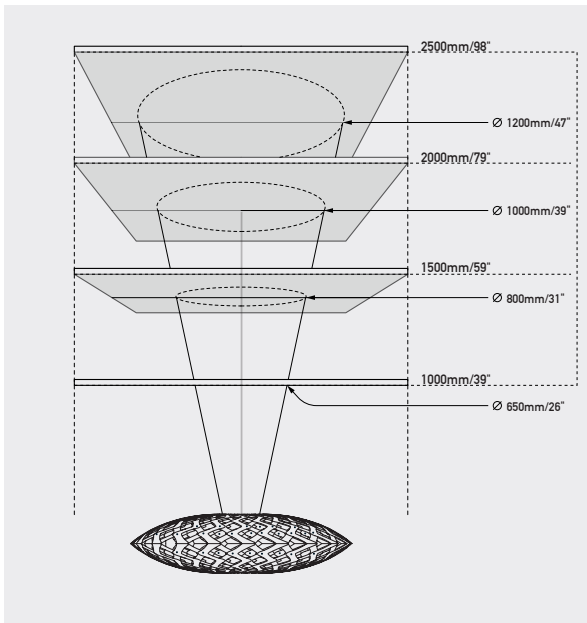
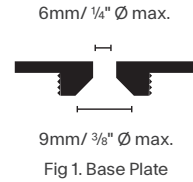

Step 1.
 Decide upon hanging distance. Use the schematic diagram as a guide to pick a circle radius to be marked out on ceiling. This circle can be marked with a length of timber or string.

Step 2.
 Mark 3 hanging points where your cone grippers will be located. You can either centrally locate the ceiling canopy or run the electric cord up one of the suspension wires.

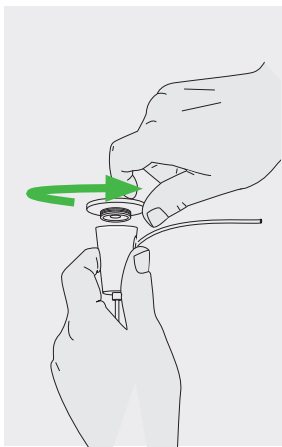

Step 3.
 Unscrew baseplate.

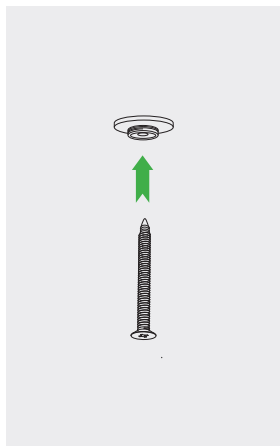

Step 4.
 Use appropriate fixing screw to mount base plate (Fig.1).

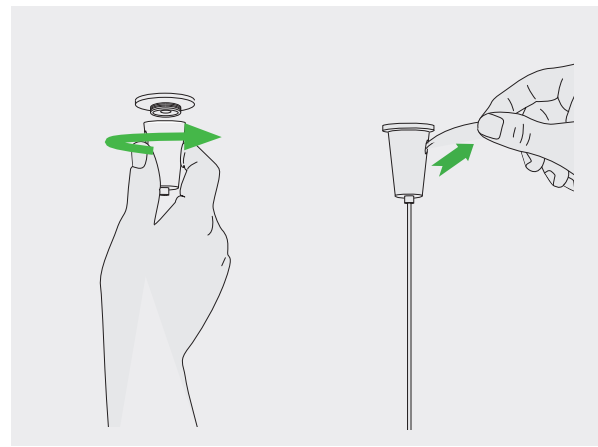

Step 5.
 Remove cable from cone. Screw cone back onto baseplate. Re-insert cable and level light. Once desired position is set, trim excess cable.